

Simple | Rugged | Accurate



Class Leading Specification:

- Capacities from 1 tonne to 1200 tonne
- Ultra rugged design
- Working Overload Range 200%
- Factor of Safety 5:1, (7:1 for Mil Spec.)
- High Accuracy - Standard $\pm 0.25\%$ (0.1% class available)
- Temperature Range -20°C to $+70^{\circ}\text{C}$
- Frequency 418MHz, 433MHz, 914MHz or 2.4Ghz
- Communication range standard 50m (600m 2.4GHz option)
- Excellent Ingress Protection - standard IP67 (IP68 subsea 5000m)
- ATEX/IECEx approved option
- HERO Approved wireless communications
- Wireless accessories - handheld displays, PC software, large displays

Dims(mm)	A	B	C	D	E	Weight	Model
1, 5 tonne	108	105	41	30	164	1.4 kg	LE05T
12 tonne	120	105	44	38	210	2.0 kg	LE12T
17 tonne	125	115	48	45	230	2.7 kg	LE17T
25 tonne	131	125	58	53	255	3.8 kg	LE25T
35 tonne	147	138	58	60	305	5.3 kg	LE35T
50 tonne	170	150	75	73	345	8.2 kg	LE50T
85 tonne	190	188	100	85	410	16.7 kg	LE85T
100 tonne	228	220	120	100	455	26.2 kg	LE100T
120 tonne	228	220	120	100	480	28.2 kg	LE120T
150 tonne	254	260	130	115	555	41.2 kg	LE150T
200 tonne	292	285	165	135	630	64.2kg	LE200T
250 tonne	330	304	190	145	680	87kg	LE250T
300 tonne	345	350	190	155	720	106kg	LE300T
400-1200 tonne	Sizes on request						

* Accuracy achieved outside ideal (laboratory) testing is dependent on the loading conditions – inline with safety and best lifting practise the rigging should be of the correct capacity and physical size, vertical, aligned and centralised and not subjected to extraneous forces such as side load or torque twist.

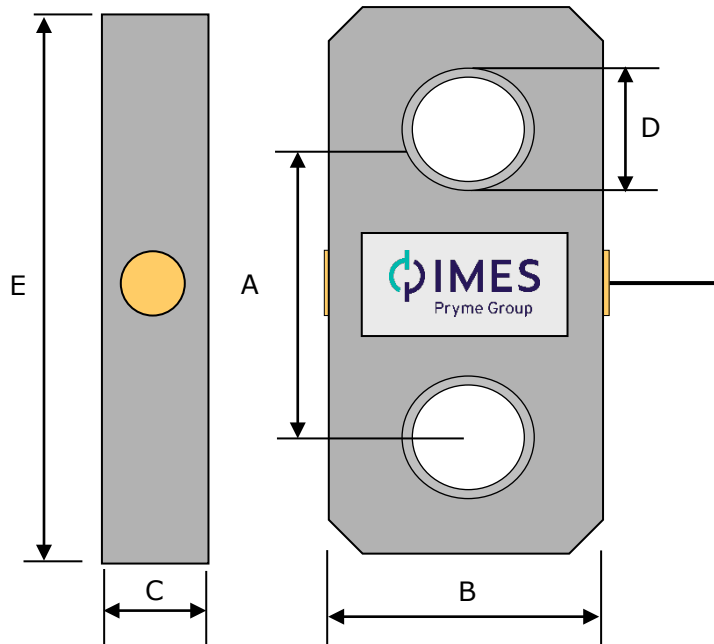

Handheld display, PC software, I-Log flat panel, Large LED display

